

Sauna heater Thermat

Wall mounted heater

For family sauna

- Outer shell: powder-coated steel sheet anthracite
- Inner shell: hot-dip aluminium coated sheet
- Rear wall: galvanized steel plate
- Stone basket: high-grade steel
- Terminal box: galvanized steel plate
- Stone filling: 15 kg incl.



CE IP x4
MADE IN GERMANY

Connection diagram

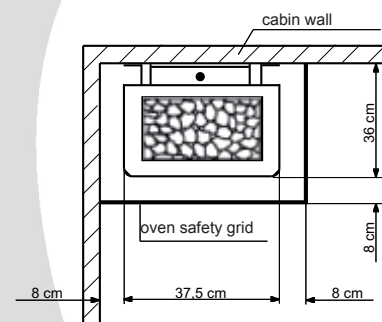
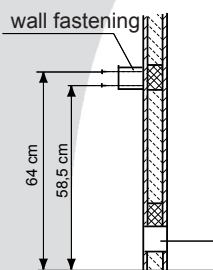
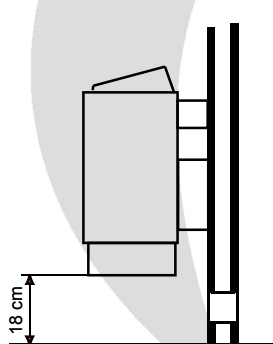
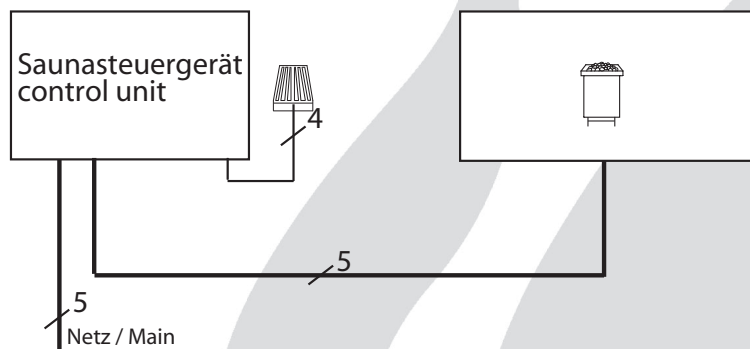

Art.-No.	Outer shell	Capacity acc. DIN	Electrical Connection	Fuse in A	Installation dimensions H/W/D cm	For cabin size	Minimum dimensions of air intake and exhaust vents	Weight without stones without package	Connecting cable main - control unit in mm ²	Connecting cable control unit - heater in mm ²	Power switch gear needed	For operation with control units
94.4819	anthracite	4,5 kW	3N AC 50 Hz 400 V	3 x 16	78* / 37,5 / 36	4 - 6 m ³	35 x 3 cm	11,0 kg	2 x 2,5	5 x 1,5	no	ECON D1 ECON D2 ECON H1 ECON H2 EMOTEC DC9000 EMOTEC DC9000 DB/DL/DLF EMOTEC HCS9003 EMOTEC HCS9003 DB/DL/DLF EmoTouch II PB/AF/GF
94.4820		6,0 kW				6 - 8 m ³	35 x 4 cm					
94.4821		7,5 kW				7 - 10 m ³	35 x 5 cm					
94.4822		9,0 kW				9 - 14 m ³	35 x 6 cm					

All cross sections of a line are minimum diameters in mm² (Copper line)

* during 18 cm ground clearance

