

ENGLISH

USER GUIDE

SENSE COMBI

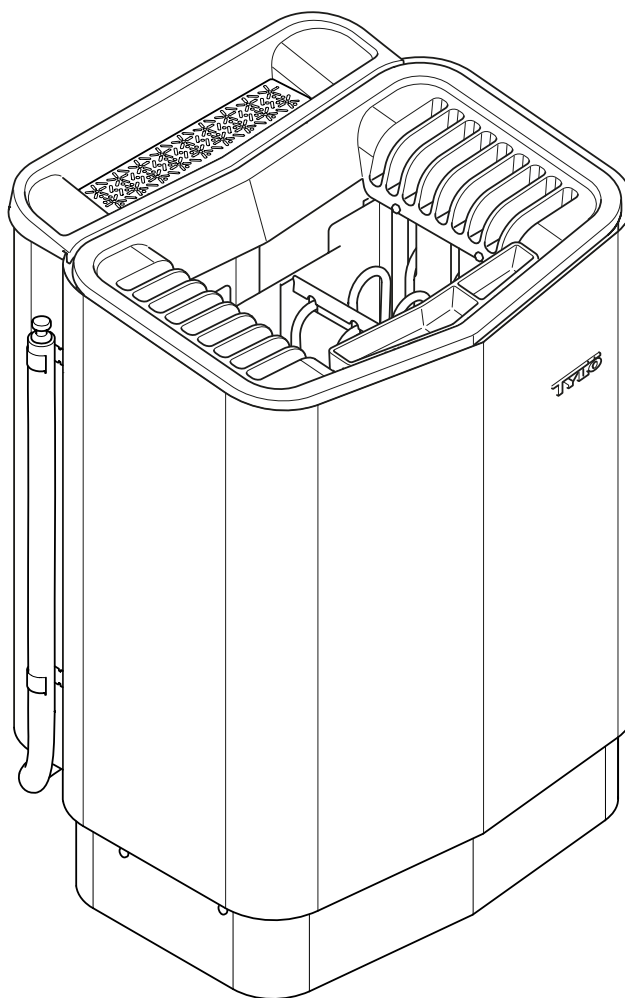

TABLE OF CONTENTS

General information	1	Troubleshooting the sauna heater	12
Before use	1	Troubleshooting the control panel	12
The first time you use the heater	1	Spare parts list	14
Before each use	3	RoHS (Restriction of Hazardous Substances)	15
Use	4		
The control panel in general	4		
Start/stop	5		
Setting temperature	5		
Setting humidity level	5		
Setting start time and calendar programming	5		
SETTINGS menu	6		
Locking the panel	7		
Drying setting	7		
Other functions	8		
External ON/OFF switch (option)	9		
General	9		
On/Off	9		
Extended sauna time	9		
Setting a function	9		
Setting Sauna time external switch	9		
Extra control panel (option)	9		
After use	10		
Empty the reservoir	10		
Switch off main power switch	10		
Maintenance	11		
Empty the water reservoir	11		
Descaling the water reservoir	11		
Cleaning the fragrance holder/air humidifier and herb bowl	11		
Check the stone compartment	11		
Troubleshooting	12		



Keep this user guide!

In the event of any problems, please contact the retailer where you purchased the equipment.

© This publication may not be reproduced, in part or in whole, without the written permission of Tylö. Tylö reserves the right to make changes in materials, construction and design.

GENERAL INFORMATION

Congratulations on your new sauna heater! Follow this user guide to get the most from your purchase.

Wet and dry saunas are forms of bathing which originate way back in history. These hot sauna baths are best at temperatures between 70-90°C.

The unique combination of a traditional sauna and a soft, mild steam bath in a single cabin is also known as a *Tylarium*.

BEFORE USE

The first time you use the heater

Fill the stone compartment

CAUTION! Always use dolerite stones (Tylö Sauna Stones). "Ordinary" stones can damage the heater. Do not use ceramic stones. Ceramic stones can damage the heater. The heater guarantee does not cover damage caused by ceramic stones.

Fill the stone compartment around the heating elements from the bottom to the top, to approx. 50 mm above the front top edge. Do not press the stones into place. Capacity: Approx. 20 kg of stones.

Place the stones loosely to allow optimum air circulation. The tubular heating elements must not be squeezed together or against the side.

Sauna stones must:

- tolerate extreme heat and fluctuations caused by water being poured on them.
- be cleaned before use.
- have an uneven surface, so that the water "clings" to the stone surface and evaporates efficiently.
- be between 30-50 mm in size to allow air circulation in the stone compartment. This will increase the life of the tubular elements.

CAUTION! Never place stones on top of the side air chambers. Covering the vents will obstruct air circulation, the unit will overheat and the cut-out switch will activate.

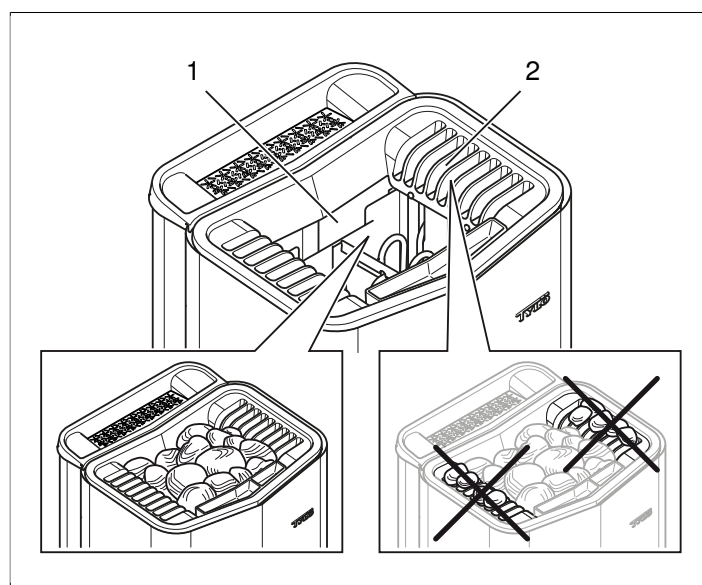

Figure 1: Filling the stone compartment

1. Stone compartment
2. Side chambers

Switch on the heater to remove any new paint odours

To remove “new paint odour” from the heater:

Heat to approx. 90°C for about one hour (see The section called **Use**, Page 4).

A little smoke may appear.

Default settings

Using the control panel for the first time:

1. Check the heater manual for getting started and safety precautions.
2. Pass your hand over the screen to light it up.
3. Select region (**Europe**, **USA**, **Other**). Use **UP** and **DOWN** to scroll through the menu. Confirm using **OK** (see **Figure 2**, Page 2).



Figure 2: UP, DOWN and OK

4. Select language. Confirm with **OK**.
5. Enter current time. Confirm with **OK**.
6. Enter current date (yyyy-mm-dd). Confirm with **OK**.
7. Select **System type** (**Timer-controlled**, **Monitored** or **Private**).

Key to system type:

System type **Timer-controlled** is used for systems in which calendar programming or delayed start are required. Maximum running time for this choice is 12 hours. After 12 hours, the system must be shut down for at least 6 hours. A door contact must also be connected to the sauna door to detect whether the door is opened after the last shut-down.

System type **Monitored** is used for systems where there are always personnel to monitor the sauna. No calendar programming or delayed start can be used with this choice.

System type **Private** is used for private systems. Max. sauna time is 6 hours. Delayed start can be used with this choice, but not calendar programming.

NOTE! A door contact can be used for all system types. The contact will detect if the sauna door is opened after the last sauna has been taken. NB: timer-controlled systems will require a check of the sauna and confirmation on the control panel.

8. Enter **Sauna time limit** (maximum time depends on system type).
9. Enter **Door contact** (**Yes**, **No**).
10. Enter **No** at **Automatic filling and emptying** (automatic water filling and emptying - applies to the Expression heater).

The control panel in general

The control panel is automatically activated when you pass your hand over it.

Use **UP** (see **Figure 3** **Figure 5**, Page 2 pos 6) and **DOWN** (pos 9) to scroll through the menus.

Use **UP** and **DOWN** to increase/decrease a value when entering data.

Confirm menu choices using **OK** (pos 8).

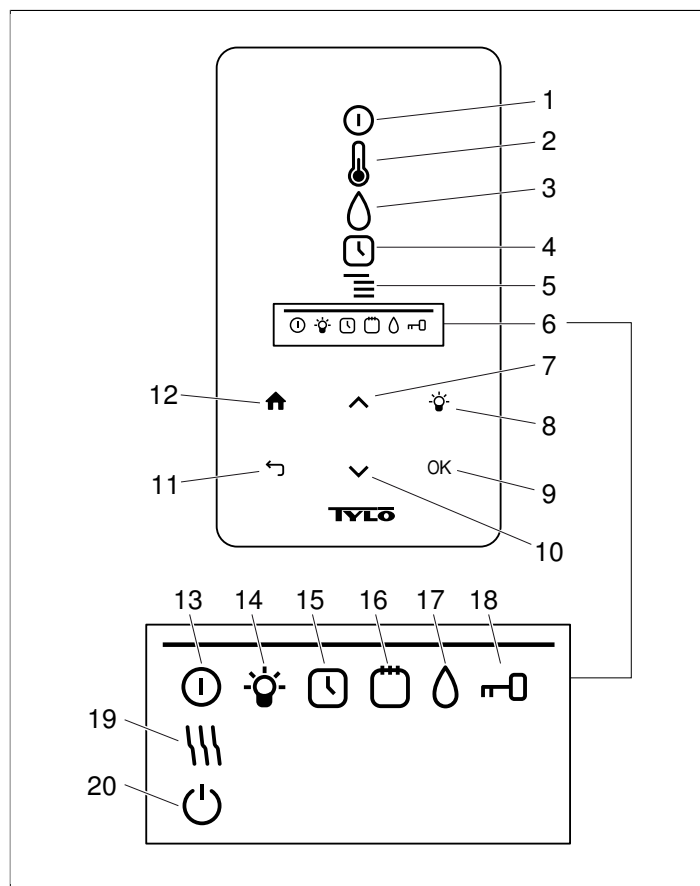

Figure 3: Main menu

1. **ON/OFF**
2. **TEMPERATURE**
3. **HUMIDITY:** Set humidity
4. **TIMER:** Program start time
5. **SETTINGS**
6. **STATUS BAR:** Shows the status of certain functions (13-20)
7. **UP:** One step up in the menu or increase value when entering data
8. **LIGHT**
9. **OK:** Confirm choice
10. **DOWN:** One step down in the menu or decrease value when entering data
11. **BACK:** Go one step back in the menu or when entering data
12. **HOME:** Return to main menu
13. **ON/OFF STATUS:** Shows that the sauna/steam bath is on
14. **LIGHT STATUS:** Shows that the light is on
15. **TIMER STATUS:** Shows that the control panel is programmed for delayed start
16. **CALENDAR STATUS:** Shows that the system is calendar-programmed
17. **HUMIDITY STATUS:** Shows approximate reservoir level
Full symbol = full reservoir, half-full symbol = half reservoir and flashing empty symbol = empty reservoir. Only applies to heaters with manual water filling.
18. **LOCKED STATUS:** Shows that the panel is locked
19. **DRYING STATUS:** Shows that the system is in Dryingsetting, replaces **ON/OFF STATUS**
20. **STANDBY STATUS:** Shows that the system is in Standbysetting, replaces **ON/OFF STATUS**

Before each use

Check the following

Check that:

- there are no foreign objects in the sauna cabin, on or in the heater.
- the door and any windows to the sauna cabin are closed.
- that the sauna door opens outwards with a little pressure.

NB:

⚠ DANGER! Anyone with a mental or physical disability or little experience of or knowledge of how to use the equipment (e.g. children) must be instructed or supervised by someone responsible for their safety.

⚠ DANGER! Do not touch the upper parts of the heater - risk of burns! Tylö recommends that the heater screen is always used.

⚠ DANGER! Never allow children to play near the heater!

⚠ DANGER! Saunas are not recommended for people in poor health. Please consult a doctor.

⚠ DANGER! Fragrant essences and similar products can ignite if poured directly onto the stones.

⚠ DANGER! Covering the heater can cause fire.

⚠ CAUTION! Never use a hose in the sauna.

☑ NOTE! Do not use the sauna cabin for any purpose other than taking saunas.

Turn on the main power switch

The main power switch is at the bottom of the heater.

Turn on the main power switch if not already on (see **Figure 4**, Page 3).

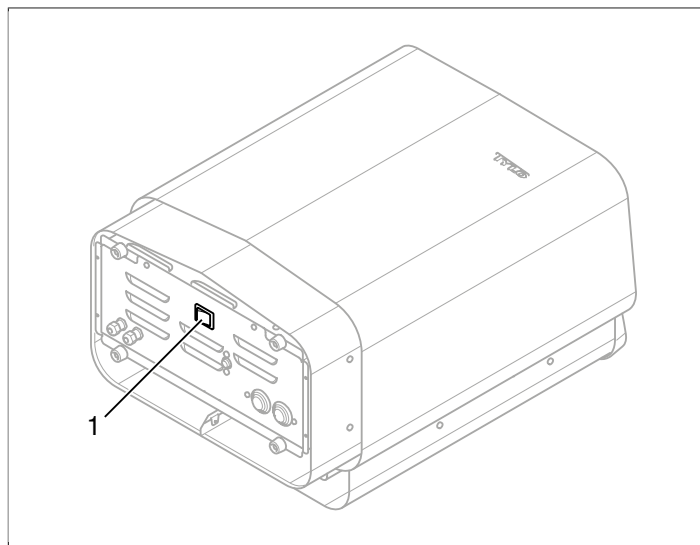

Figure 4: Location of main power switch

1. Main power switch

USE

The control panel in general

The control panel is automatically activated when you pass your hand over it.

Use **UP** (see *Figure 3* *Figure 5*, Page 2 pos 6) and **DOWN**(pos 9) to scroll through the menus.

Use **UP** and **DOWN** to increase/decrease a value when entering data.

Confirm menu choices using **OK** (pos 8).

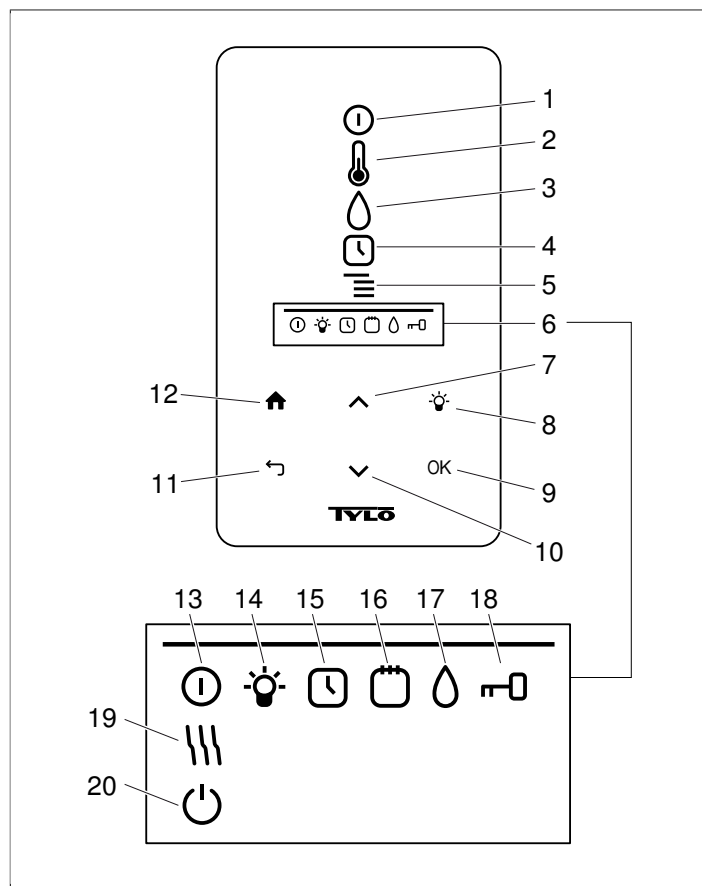

Figure 5: Main menu

1. **ON/OFF**
2. **TEMPERATURE**
3. **HUMIDITY**: Set humidity
4. **TIMER**: Program start time
5. **SETTINGS**
6. **STATUS BAR**: Shows the status of certain functions (13-20)
7. **UP**: One step up in the menu or increase value when entering data
8. **LIGHT**
9. **OK**: Confirm choice
10. **DOWN**: One step down in the menu or decrease value when entering data
11. **BACK**: Go one step back in the menu or when entering data
12. **HOME**: Return to main menu
13. **ON/OFF STATUS**: Shows that the sauna/steam bath is on
14. **LIGHT STATUS**: Shows that the light is on
15. **TIMER STATUS**: Shows that the control panel is programmed for delayed start
16. **CALENDAR STATUS**: Shows that the system is calendar-programmed
17. **HUMIDITY STATUS**: Shows approximate reservoir level
Full symbol = full reservoir, half-full symbol = half reservoir and flashing empty symbol = empty reservoir. Only applies to heaters with manual water filling.
18. **LOCKED STATUS**: Shows that the panel is locked
19. **DRYING STATUS**: Shows that the system is in Dryingsetting, replaces **ON/OFF STATUS**
20. **STANDBY STATUS**: Shows that the system is in Standbysetting, replaces **ON/OFF STATUS**

Start/stop

To start the heater:

1. Pass your hand over the screen to light it up. **ON/OFF** is marked (light intensity increases) (see **Figure 6**, Page 5).



Figure 6: ON/OFF and ON/OFF STATUS

2. If **ON/OFF** is not marked, use **UP** to scroll to the correct position.
3. Press **OK**. **ON/OFF STATUS** will light up in the **STATUS BAR** (see **Figure 3**/**Figure 5**, Page 2) to show that the sauna heater is on.

When the heater is on, the temperature and time will be shown if no other settings have been changed.

To switch off, select **ON/OFF** and press **OK**.

NOTE! When the heater is switched off or the set operating time expires, it will switch to the drying setting. The heating element will run for 20 minutes to dry out the sauna cabin. This can be deactivated by pressing **ON/OFF**. When the heater is off, the control panel light will go out. It is automatically activated when you pass your hand over the panel. Tylö recommends using the Drying setting.

Setting temperature

To set sauna temperature:

1. Select **TEMPERATURE** (see **Figure 7**, Page 5) and press **OK**.

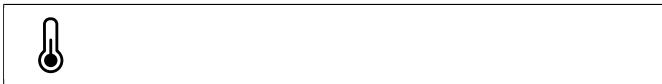

Figure 7: TEMPERATURE

2. Use **UP** and **DOWN** to set the temperature and confirm with **OK**.

At temperature settings over 70°C, sauna cabin heating will be prioritised; at temperature settings under 70 °C, steam production will be prioritised. Prioritisation can be changed in **Settings** (see The section called **SETTINGS** menu, Page 6).

Setting humidity level

To set humidity level:

1. Select **HUMIDITY** (see **Figure 8**, Page 5) and press **OK**.



Figure 8: HUMIDITY/HUMIDITY STATUS for empty, half-full and full reservoir.

2. Set the desired humidity level on the scale of 0-10 (0 = dry sauna and 10 = max. humidity). Confirm with **OK**.

Water level in the reservoir is indicated by **HUMIDITY STATUS** (see **Figure 8**, Page 5) in the **STATUS BAR** (see **Figure 3**/**Figure 5**, Page 2, pos 6). An illuminated, full drop symbol shows the reservoir is full. An illuminated half-full symbol shows the reservoir is half full and a flashing empty symbol shows the reservoir is empty. When starting, an empty reservoir will also be indicated by a pulsating audio signal.

If the water runs out during your sauna, this will be indicated by a pulsating audio signal and flashing symbol on the panel. When filling with water, **HUMIDITY STATUS** will first change to half-full and then to full, and a steady audio signal will indicate that the reservoir is full.

Fill the water reservoir by carefully pouring water through the grille.

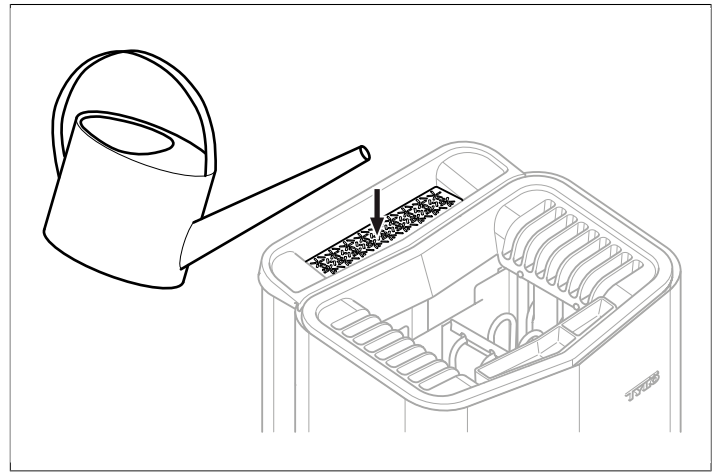

Figure 9: Filling the water reservoir.

Setting start time and calendar programming

You can set a time when the heater is to start up to 24 hours in advance. You can also set up a weekly program (activities) of start and stop times, temperature, which days the program applies to (up to one week in advance) and select whether the activity should be repeated or not.

To set up a start time:

1. Select **TIMER** (see **Figure 10**, Page 5).



Figure 10: TIMER and TIMER STATUS

2. Press **OK**.
3. Select **Timer**.
4. Select **Start time**.
5. Enter the start time and set the correct time. Use **UP/DOWN** to increase or decrease the value. Confirm each digit with **OK**.

When a time is programmed, **TIMER STATUS** (see **Figure 10**, Page 5) is shown in the **STATUS BAR** in the main menu.

To activate a preprogrammed time:

1. Select **TIMER**.
2. Select **Activate**.
3. Confirm with **OK**.

To activate a program:

1. Select **TIMER**.
2. Select **Activate**.
3. Confirm with **OK**.

To set up a weekly program (an activity):

1. Select **TIMER**.
2. Press **OK**.
3. Select **Calendar**.
4. Select **New activity**.
5. Enter start time, end time, temperature, humidity, activity type (**On** or **Standby**), the day(s) the activity applies to and whether the activity should repeat every week. Use **UP/DOWN** to increase/decrease a value, and confirm with **OK**.

Key to activity type:

On means that the set temperature/humidity will be used.

If **Standby** is selected, the temperature will be reduced by a predefined number of degrees (default 20 °C). When users enter the sauna, they press the external switch or control panel and the sauna will quickly heat up to the temperature set. **Standby** is indicated on the control panel by **STANDBY STATUS** (see **Figure 11**, Page 6).



Figure 11: STANDBY STATUS

When choosing a day, every day of the week will be shown. Use the **UP/DOWN** arrows to select which day the activity will apply to, and confirm with **OK**. More than one day can be selected. The days selected will be indicated by a mark on the right.

When the day/days have been selected, go down to **>** and confirm with the **OK** symbol. Select whether the activity will apply to this week or all weeks. When an activity is set up, it is shown by **CALENDAR STATUS** (see **Figure 12**, Page 6) appearing in the status bar.



Figure 12: CALENDAR STATUS

Several activities can be set up. When the first activity is ready and you want to set up a new one, select **New activity** in the calendar menu. Up to 30 activities can be set up.

To edit an activity:

1. Select **TIMER**.
2. Select **CALENDAR**.
3. Select the activity you want to edit.
4. Select **Edit**.
5. To edit your choice, see The section called **Setting start time and calendar programming**, Page 5, Set up a weekly program (an activity) step 5.

To delete an activity:

1. Select **TIMER**.

2. Select **CALENDAR**.
3. Select the activity to delete.
4. Select **Remove**.
5. Select **Yes**.
6. Confirm with **OK**.

SETTINGS menu

There are extra functions in the **SETTINGS** (see **Figure 13**, Page 6 to enter various parameters. You can also reset the control panel to factory settings under this menu.



Figure 13: SETTINGS

SETTINGS has the following sub-menus:

- **Sauna**
- **General**: You can set a range of parameters here, such as time, date, language etc.
- **Service**: You can change the default parameters under the service menu.

Sauna

Sauna sub-menus:

- **Bath type priority**: Select how heating up is to be prioritised. The basic priority is automatic (under 70°C steam production is prioritised. Heating up the cabin is prioritised over 70°C). The sauna priority means that steam production will not start until the cabin has reached the set temperature. Steam priority means that steam production is prioritised, but two of the heater elements will activate to heat up the cabin.
- **Standby**: You can define by how much the temperature will be reduced when the heater is programmed for **Standby**.

General

General sub-menus:

- **Enter time**: Set the timer
- **Enter date**: Enter date here
- **Region**: Set language, temperature format (°C/°F) and time format (12 or 24 hour).
- **Delay function**: The time from when the control panel becomes inactive until the display shuts down. This can also be used to shut off the Delay function.
- **Button lock**: Button lock - You can choose automatic button lock (the panel locks after a given time. Can be unlocked by pressing **HOME** and **BACK** simultaneously (see **Figure 14**, Page 7), to lock the panel using a code (to use the panel the correct code has to be entered) and change the lock code. You can also define the time interval that should elapse before the code lock is activated. For more details, see The section called **Locking the panel**, Page 7.
- **Vibration**: You can select whether the panel will vibrate slightly when pressing the buttons or not.
- **About**: Shows details of the system. Indicates which software and hardware versions and product are in use.



Figure 14: HOME and BACK

Service

To access the service menu, enter code 124.

Service sub-menus:

- **Settings** sub-menus:
 - **Sauna time limit:** The maximum time allowed for using the sauna.
 - **Sauna time external switch:** Defines the sauna time when an external switch is used
 - **External switch function:** Select between **On/Off** and **Restart sauna time**. See section on external switch.
 - **Temperature limit:** Maximum sauna temperature
 - **Overheating limit:** When the temperature on the circuit board exceeds a set temperature, the heater will shut down to prevent damage to the electronics or other components. The function can be cancelled and the temperature limit changed. Changing the temperature is not recommended without finding out what caused the temperature increase in the electronics.
 - **Filtered temperature:** Defines whether you want to see an exact value at the thermistor. To prevent large temperature fluctuations on the display, the filtered value should be shown.
 - **Reset pause timer:** When a timer-controlled system is selected, the mandatory pause of 6 or 12 hours can be reset here.
- **Diagnosis** sub-menus:
 - **Relay control:** For Tylös service technicians only
 - **Extra relay control:** For Tylös service technicians only
 - **System status:** Shows the current status of water level, sauna temperature, sauna hours, system type and product.
 - **Heater grid node list:** Shows which products are connected to the system.
 - **Error log:** Any errors on the system are logged here.
- **Factory settings** Code 421 is required to reset to factory settings. The control panel will reset to factory settings.

Locking the panel

The panel can be locked to prevent unauthorised setting. To lock the panel, press **HOME** and **BACK** simultaneously for 2 seconds (see **Figure 15**, Page 7).



Figure 15: HOME and BACK

When the panel is locked, **LOCKED STATUS** (see **Figure 16**, Page 7) is shown in the status bar.



Figure 16: LOCKED STATUS

To unlock the panel, press **HOME** and **BACK** simultaneously for about 2 seconds.

NOTE! When the control panel is locked, the light button will still work.

The panel can be set to automatically lock the buttons. Locking can be performed with or without a code.

To program automatic button lock:

1. Select **Settings**.
2. Select **General**.
3. Select **Button lock**.
4. Select **Activate with code** or **Activate without code** depending on whether a code is needed.

If selecting **Activate with code** the code should be changed. Change code by selecting **Enter code**. Enter the existing code first (default is 0000) and then the new code. Confirm the new code.

NOTE! If the panel is code-protected, an external switch connected to the panel will still work. For this function, see The section called **External ON/OFF switch (option)**, Page 9.

To enter how long it takes before the panel automatically locks:

1. Select **Settings**.
2. Select **General**.
3. Select **Button lock**.
4. Select **Delay**.
5. Enter the time until panel lock (10 sec. - 5 min., default is 15 sec.).

Drying setting

Once operating time expires or the heater is switched off via **OFF**, the sauna will start drying (if the water reservoir has been in use, humidity setting 1-10). Drying is active for 20 minutes, after which the heater will switch off. The drying setting can also be cancelled manually by pressing **OFF**. The drying setting will be shown in the status bar by **ON/OFF STATUS** changing to **DRYING STATUS** (see **Figure 17**, Page 7).



Figure 17: DRYING STATUS

Other functions

Fragrance holder

 **DANGER!** Never put fragrances in the herb bowl or water reservoir.

 **DANGER!** Fragrant essences etc. may ignite if poured directly onto the stones.

To create a pleasant fragrance in the sauna, pour a few drops of Tylö Sauna Fragrance into the water in the fragrance holder.

You can also mix a few drops of the sauna fragrance with water in a sauna bucket and pour the water on fully heated stones. Use a sauna ladle for pouring water on the hot stones.

Tylö Sauna Fragrance comes in six fragrances:

- eucalyptus,
- mint,
- menthol,
- pine,
- lemon
- and birch.

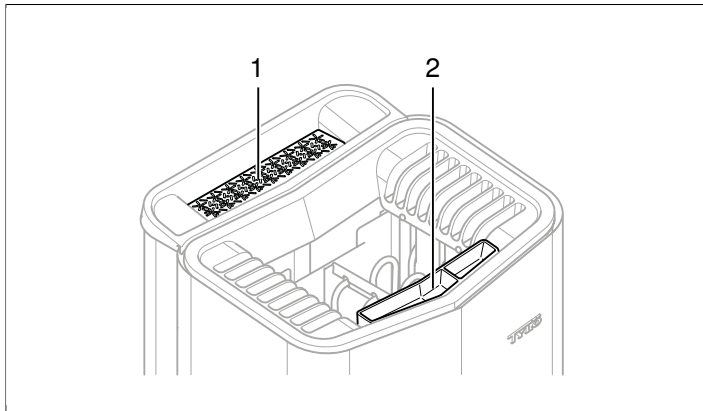



Figure 18: Other functions

1. Herb bowl
2. Fragrance holder/air humidifier

Herb bowl

A fragrant, refreshing herbal sauna can be created with fresh or dried herbs or spices. Enjoy pleasant herbal fragrances in a steamy tropical climate.

To create a fragrant sauna using fresh or dried herbs, put the herbs in the herb bowl (see **Figure 18**, Page 8).

 **TIP!** Try different combinations, such as birch, lavender, mint, spices, tea bags and other exciting fragrances.

Air humidifier

 **WARNING!** Do not confuse the instructions for the air humidifier with those for the water reservoir.

 **DANGER!** Do not pour water into the fragrance holder once it has been heated up, as this can cause boiling water to splash on the sauna occupants. Do not stand or sit in front of the heater while water is being poured into the fragrance holder, as hot water can splash out suddenly.

To maintain a pleasant basic humidity in the sauna, fill the built-in air humidifier (see **Figure 18**, Page 8) with water before switching on the sauna.

 **TIP!** Pour a few drops of diluted sauna fragrance into the built-in air humidifier.

EXTERNAL ON/OFF SWITCH (OPTION)

General

External ON/OFF switches are available with impulse or constant deactivation. The control panel detects automatically which deactivation is used. However, the switch function can vary depending on deactivation. Switches with constant deactivation can only use the **On/Off** function. Impulse switches can be given various functions, depending on whether they can be programmed with **On/Off** or **Extended sauna time**.

On/Off

On/Off (impulse and constant deactivation, not suitable for calendar programming)

Switches with constant deactivation:

- To run the system for a preprogrammed time in **Sauna time external switch**: press the switch once.
- To switch off the system, press the switch once more.

Impulse switches:

- To run the system for a preprogrammed time in **Sauna time external switch**: press the switch once. (Functions if the system is in *Standby* or *Off*.)
- To switch off the system, press the switch once more. (If the heater is in a program, it will be shut down and wait for a new program or new *On*-activation.)

Extended sauna time

Extended sauna time (with impulse only):

- To run the system for a preprogrammed time in **Sauna time external switch**: press the switch once.
- To restart the time, press once more.
- When the time has expired, the heater will return to the setting it would have been in if the switch had not be activated.

Setting a function

To set a function for impulse switches:

1. Select **Settings**.
2. Select **Service**.
3. Select **Settings**.
4. Select **External switch function**.
5. Select between **On/Off** and **Extended sauna time**.

Setting Sauna time external switch

To define the sauna time for pressing the external switch:

1. Select **Settings**.
2. Select **Service**.
3. Select **Settings**.
4. Select **Sauna time external switch**:
5. Enter the time and confirm with **OK**.

EXTRA CONTROL PANEL (OPTION)

All connected control panels work in parallel, i.e. making a selection on one panel will activate the same selection on the other connected units. However, there are certain individual settings which do not affect running of the heater, but which are selected on each panel:

- **Automatic button lock on/off**
- **Code lock on/off**
- **Delay time**
- **Vibration on/off**

AFTER USE

Empty the reservoir

⚠ DANGER! Hot water! Wait until the water has cooled before completing this step.

To prevent the build-up of limescale, empty the reservoir after each bath.

To empty:

1. Slacken the hose from the hose clip.
2. Hold the hose up and remove the plug.
3. Lower the hose into a suitable container and drain off the remaining water.
4. Hang the hose on the hose clip.

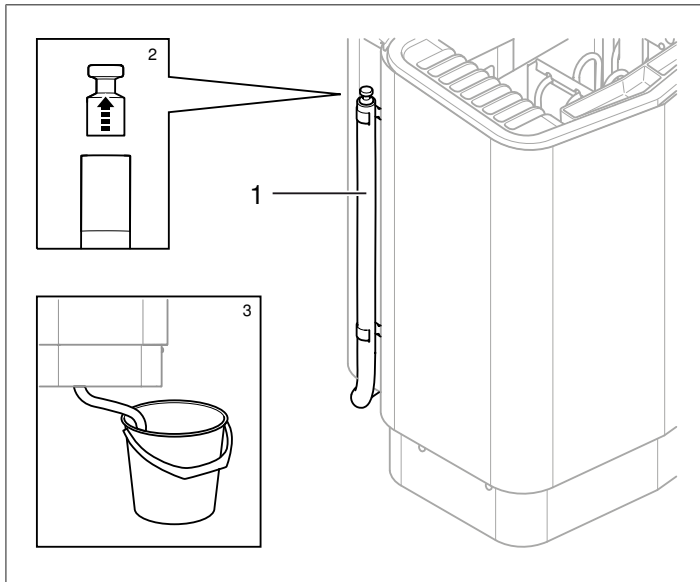

Figure 19: Emptying the water reservoir.

1. Water reservoir hose.
2. Remove plug
3. Lower hose into a suitable container

Switch off main power switch

⚠ CAUTION! The heater's memory function will be cancelled if disconnected from the mains for more than 7 days. The date and time will have to be reprogrammed.

The main power switch is at the bottom of the heater.

Switch off here when the heater is not to be used for an extended period (e.g. several weeks).

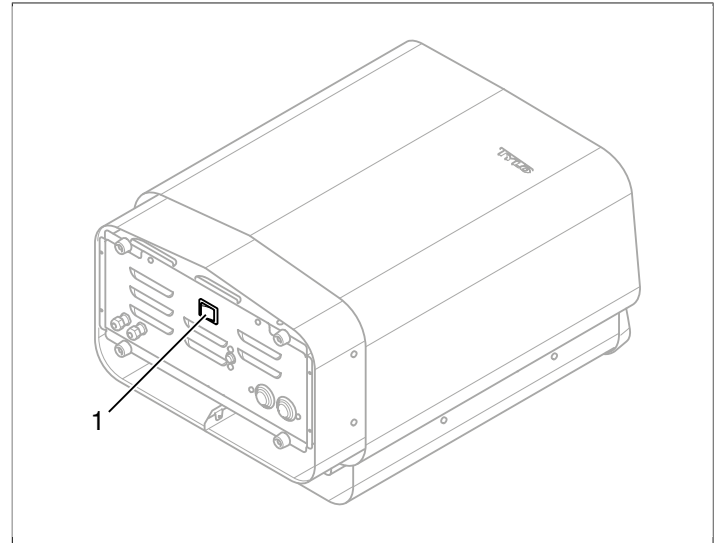

Figure 20: Location of main power switch

MAINTENANCE

After each use	As required	Once annually
Empty the water reservoir.	Descal the water reservoir.	Check the stone compartment.
	Clean the herb bowl and fragrance holder.	

Empty the water reservoir

Empty the water reservoir after each use.

To empty the water reservoir see The section called **Empty the reservoir**, Page 10.

Descaling the water reservoir.

Descal the water reservoir as required using Tylö Solvent descaling agent.

How to descale:

1. Start the steam function (see The section called **Use**, Page 4) and run until the water boils.
2. Switch off the heater, and wait for about 5 minutes.
3. Mix 1 bag (80 g) Tylö Solvent descaling agent with 4 dl of water and pour into the water inlet.
4. Leave the descaling agent to work for 1 hour, empty the reservoir and rinse thoroughly.
5. If necessary, repeat the procedure several times until all limescale has been removed.

Cleaning the fragrance holder/air humidifier and herb bowl

Clean the fragrance holder/air humidifier and herb bowl as required.

To clean the fragrance holder/air humidifier and herb bowl:

Lift out the fragrance holder/air humidifier and herb bowl and rinse them under running water.

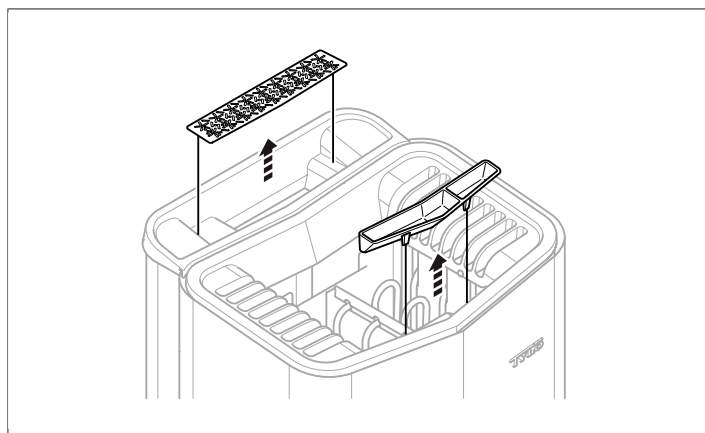

Figure 21: Cleaning the fragrance holder/air humidifier and herb bowl

Check the stone compartment

Check the stone compartment once annually.

How to check the stone compartment:

1. Remove all the stones from the compartment.
2. Remove any small stones, gravel and limescale from the compartment.
3. Put whole, undamaged stones back. Replace damaged stones with new ones as required (see The section called **Fill the stone compartment**, Page 1).

TROUBLESHOOTING

Troubleshooting the sauna heater

Table 2: Troubleshooting the sauna heater

Symptom	Possible cause	Remedy
Heater works but no steam is created	Water reservoir temperature cut-out activated.	Reset the water reservoir temperature cut-out. For more information, see The section called Temperature cut-out , Page 12.
Heater is not working.	Main power switch is off.	Switch on.
Heater is not working.	Fuse blown/tripped	Replace/reset fuse.
Heater is not working.	Internal temperature cut-out activated. For more details, see The section called Temperature cut-out , Page 12.	Check and remedy the cause of temperature cut-out activation. Contact an electrician to reset the cut-out.

Temperature cut-out

The heater has several temperature cut-out devices:

- One of the temperature cut-outs protects the electronics from overheating. If the electronics in the heater overheat, an error message will appear on the control panel display and the heater element will shut off automatically. If the overheating protection in the electronics cuts out, it will restart automatically when the temperature cools down.
- Another temperature cut-out in the water reservoir protects the element from boiling dry. There is a red button under the heater which can be pressed in (see **Figure 23**, Page 12). If the temperature cut-out has been triggered, you will hear a click when you press it in. If the cut-out has not been triggered, the button will feel springy.
- The sensor temperature cut-out prevents the sauna woodwork from overheating. If the sensor temperature cut-out is triggered, the electricity supply to the heater will cut off. When the temperature in the sauna cools down, it can be reset. The cause of the overheating must be established before resetting the temperature cut-out. To reset it, press the spring-loaded button with a small implement such as a paper clip (see **Figure 22**, Page 12).
- The control panel temperature cut-out protects the electronics in the panel from overheating if it is installed inside the sauna. If the control panel overheats, an error message will appear on the control panel display and the element will shut down. If the overheating protection in the control panel is triggered, it will restart automatically when the temperature cools down.

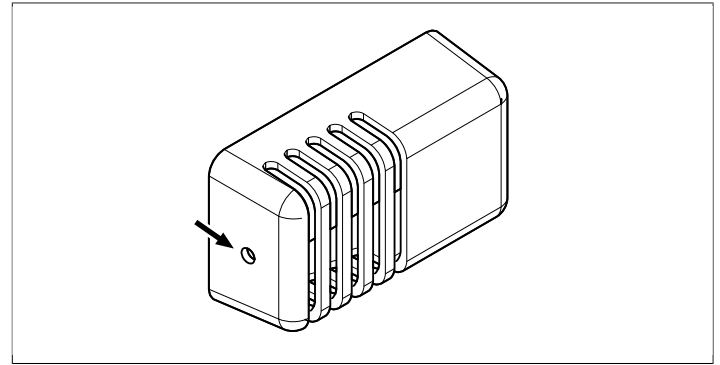

Figure 22: Resetting the sensor temperature cut-out

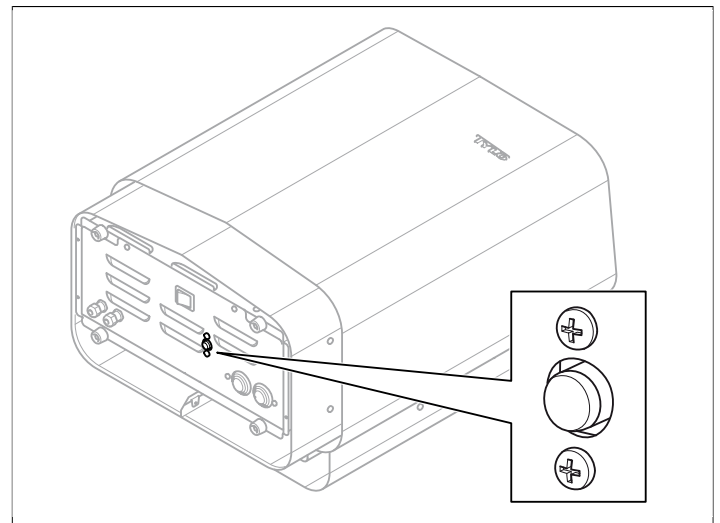

Figure 23: Resetting the temperature cut-out

Troubleshooting the control panel

Table 3: Power outage. Set time.

Message	“Power outage. Set time.”“Power supply disrupted. Reset timer.”
Code	0x000A
Comments	Realtime timer reset.
System status	Time and date set to default.
Remedy	Enter current time and date.

Table 4: Empty tank

Message	“Empty tank.”“Empty tank.”
Code	0x000B
Comments	Error in initial setup.
System status	Error message panel.
Remedy	Factory settings. Select No for automatic emptying.

Table 5: Sauna temperature sensor failure

Message	“Sauna temperature sensor failure.”“Error on the temperature sensor in the sauna.”
Code	0x0001
Comments	The thermistor in the sauna has short-circuited or is not connected.
System status	The sauna session in progress will be terminated. A new session cannot be started.
Remedy	Check cables and connections. Try a new thermistor.

Table 6: Electronics in heater overheated

Message	“Electronics in heater overheated.”“The heater electronics have overheated.”
Code	0x0003
Comments	Temperature in control box circuit board higher than 70 °C.
System status	The sauna session in progress will be terminated. New sauna session cannot start until the temperature is below 70 °C.
Remedy	Wait until the temperature is below 70 °C.

Table 7: Electrode failure

Message	“Electrode failure.”“Level indicator.”
Code	0x0005
Comments	Error in initial setup.
System status	Error message panel.
Remedy	Factory settings. Select No for automatic emptying.

Table 8: Lost contact with control panel

Message	“ Lost contact with control panel.”“ Lost contact with the control panel.”
Code	0x0006
Comments	The system has restarted because the control box could not communicate with one of the control panels.
System status	The control box will restart after 60 seconds when connection to the control panel is lost.
Remedy	Restarting the system. Check cables and connections. Replace control panel.

Table 9: Lost contact with temperature/humidity sensor

Message	“Lost contact with temperature/humidity sensor.”“Lost contact with the temperature/humidity sensor.”
Code	0x0007
Comments	The system has restarted because the control box could not communicate with one of the sensors.
System status	The control box will restart after 60 seconds when connection to the control panel is lost.
Remedy	Restarting the system. Check cables and connections. Replace sensor.

Table 10: Hardware error. Contact service.

Message	“Hardware error. Contact service.”“Hardware error. Contact customer service.”
Code	0x0009
Comments	Realtime timer not working.
System status	Timer time and date not updated.
Remedy	Restarting the system. If same error recurs, the circuit board in the control box may need replacing.

Table 11: Firmware panic 0x%02x!

Message	“Firmware panic 0x %02x!”“Disconnect from mains and contact Service.”
Code	0x0010
Comments	An error has occurred in the software.
System status	The system will restart when the error has been corrected.
Remedy	Restarting the system. If the error recurs, contact Service.

Table 12: There is more than one temperature sensor connected.

Message	“There is more than one temperature sensor connected.”
Code	0x0012
Comments	More than one temperature sensor is connected to the heater network.
System status	None.
Remedy	Disconnect all sensors except one.

SPARE PARTS LIST

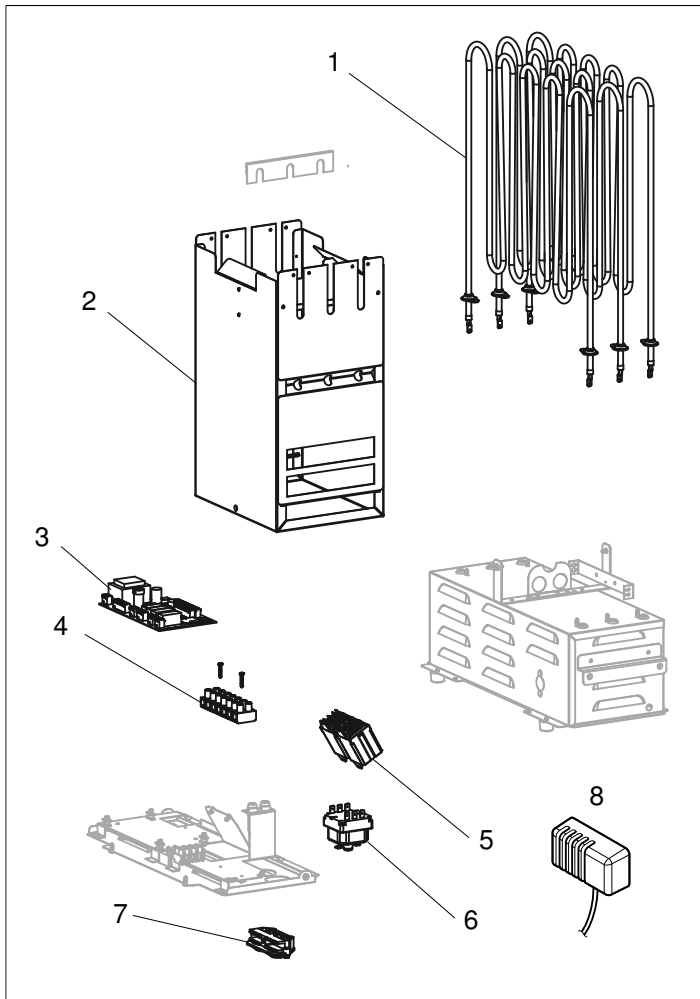

Figure 24: Spare parts 1

1. 9600 0177 / 8 kW, 9600 0178 / 6 kW Tubular element
2. 9600 0728 Stone compartment
3. 9600 0105 Circuit board
4. 9600 0723 Terminal block
5. 9600 0041 Relay 3-pole
6. 9600 0002 Temperature cut-out
7. 9600 0554 Strain relief connector
8. 9600 0005 Sensor/Temp. cut-out 130°

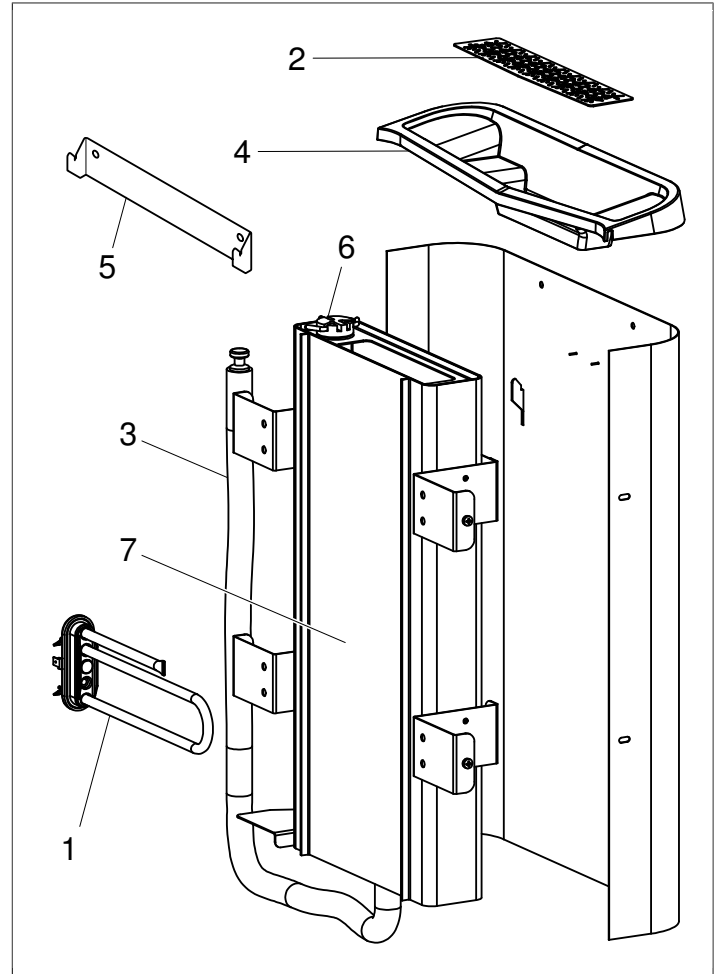

Figure 25: Spare parts 2

1. 9600 0223 Tubular element
2. 9600 0730 Herb bowl
3. 9600 0731 Hose with plug
4. 9600 0732 Filler grille
5. 9600 0733 Wall bracket
6. 9600 0734 Electrodes
7. 9600 0193 Water reservoir

ROHS (RESTRICTION OF HAZARDOUS SUBSTANCES)

Instructions for environmental protection:

Do not dispose of this product with the domestic refuse when no longer in use. Take it to a recycling station for electrical and electronic equipment instead.

For further information, see the symbol on the product, manual or packaging.

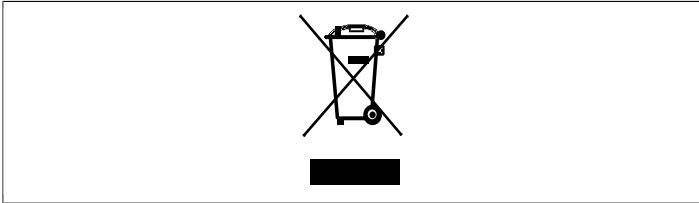

Figure 26: Symbol

The different materials can be recycled as specified by their labelling. You can help protect the environment by recycling or re-using the spent appliances or the materials in them. Take the product to a recycling centre without the sauna stones or the soapstone jacket (if fitted).

Contact your local authorities for details of your nearest recycling centre.

TYLÖ®